

1. Introduction

The Telis 16 RTS remote control allows you to control up to 16 end-products or groups of end-products using Radio Technology Somfy (RTS).

2. Safety

2.1. Safety and responsibility

Please read this guide carefully before installing and using this product.

This Somfy product must be installed by a professional motorisation and home automation installer for whom this guide is intended.

Moreover, the installer must comply with current standards and legislation in the country in which the product is being installed, and inform his customers of the operating and maintenance conditions for the product.

Any use outside the sphere of application defined by Somfy is forbidden. This invalidates the warranty and discharges Somfy of all liability, as does any failure to comply with the instructions given herein.

Before beginning installation, check that this product is compatible with the associated equipment and accessories.

2.2. Specific safety advice

Do not spill liquid on the product or immerse it in liquid.

Do not use abrasive products or solvents to clean the product.

3. Contents

Table with 3 columns: Q., Description, and quantity. Includes Telis 16 RTS, Wall mount, Screw kit, and Type AAA (LR3) batteries.

4. The Telis 16 RTS in detail

- Figure B: a. Number of the selected channel (1...16), b. Pictogram(s) of the selected channel, c. "Low battery" symbol, d. Set mode active, e. Name of the selected channel, f. Selection button, g. Navigation buttons, h. Up button, i. Stop button, j. Down button, k. PROG button, l. Battery cover.

5. Commissioning

Before using the Telis 16 RTS, we recommend that each motor be programmed in advance using an individual Telis 1 RTS type control point and that the limit positions of each motor be set. However, the Telis 16 RTS may be used for motor commissioning operations, as would any RTS remote control unit (limit position adjustment...).

This guide describes commissioning using only an individual RTS control point as Telis 1 RTS. For commissioning with a different RTS control point, refer to the corresponding guide.

5.1. Battery installation

- Remove the battery cover from the back of the Telis 16 RTS. Insert the 2 type AAA (LR3) batteries following the polarity indicated. Replace the battery cover on the rear of the Telis 16 RTS. Never use rechargeable batteries.

Replace the batteries when the (c) symbol appears on the display.

5.2. Adding / deleting a Telis 16 RTS

If necessary, wake the Telis 16 RTS by pressing any button.

- 1) Press the PROG button on the Telis 1 RTS until the end-product moves back and forth. 2) Use the navigation buttons (g) to select the channel of the Telis 16 RTS to be programmed. 3) Briefly press the PROG button (k) on the Telis 16 RTS: the end-product moves back and forth, and the Telis 16 RTS is programmed or deleted.

Somfy hereby declares that this product is in compliance with the essential requirements and other relevant provisions of Directive 1999/5/EC. A declaration of conformity can be found at the Internet address www.somfy.com/ce.

US products (With FCC ID on the label product): This device complies with Part 15 of the FCC Rules. Operation is subject to the following two conditions: this device may not cause harmful interference, and this device must accept any interference received, including interference that may cause undesired operation.

Warning! Changes or modifications not expressly approved by the manufacturer could void the user's authority to operate the equipment.

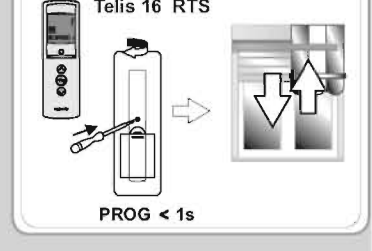
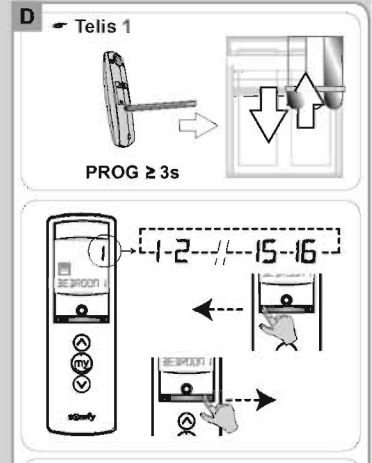
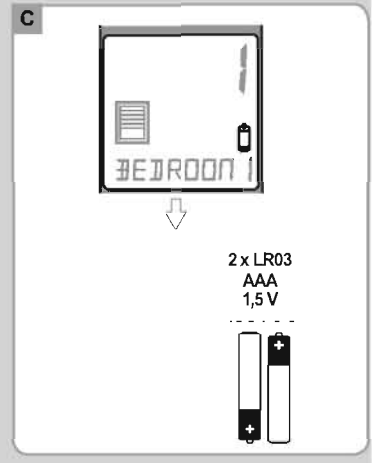
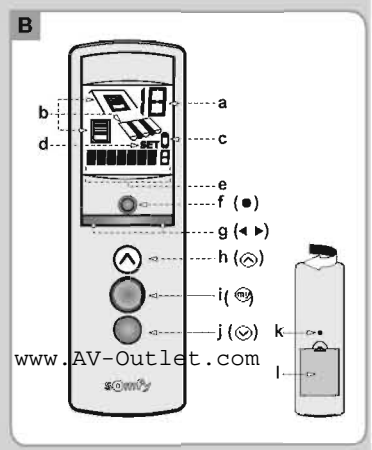
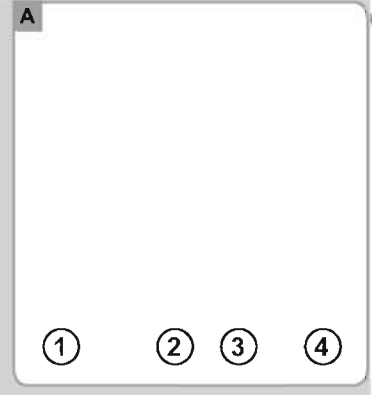

Copyright © 2010 Somfy SAS. All rights reserved. Somfy SAS, capital 20.000.000 Euros, RCS Annecy 303.970.230 - 01/2010

EN 5.3. Channel customisation

Figure E

- Selecting a channel: 1) Use the navigation buttons (g) to select the channel of the Telis 16 RTS to be customised. Selecting a pictogram: 2) Press and hold the selection button (f) until "SET" (d) appears on the display: the "SET" mode is enabled. 3) Select the pictograms to be displayed using the navigation buttons (g). 4) Briefly press the selection button (f) to validate and continue to the "Channel naming" step.

- Channel naming: 5) Select the location of the character to be edited using the navigation buttons (g): the flashing hyphen corresponds to the character to be edited. 6) Briefly press the selection button (f) to edit the character present in this location. The first 7 characters are alphabetic (A to Z) and the last character is a digit (0 to 9). 7) The character flashes: press the arrow buttons (g) to select another character. 8) Briefly press the selection button (f) to save the character displayed and continue to the next character. 9) Repeat steps 5 to 8 for each of the characters in the channel's name. 10) Press and hold the selection button (f) until "SET" (d) no longer appears on the display: the "SET" mode is disabled.

- Other customisations: 11) Repeat steps 1 to 10 with another channel that you want to customise.

6. Installation

Check the radio transmission range before mounting the Telis 16 RTS. The radio range is 20 m through 2 concrete walls.

- Select a location for the wall mount. Mark the screw locations (vertical spacing: 40 mm). Drill, then secure the mount with the screws (use anchors as required). Fit the screw cap. The use of radio appliances (e.g. Hi-Fi radio headphones) operating on the same frequency may cause interference and reduce the product's performance. Never install the Telis 16 RTS on or near metallic surfaces as doing so may reduce the radio transmission range.

7. Use

- Figure G: If necessary, wake the Telis 16 RTS by pressing any button. Use the arrow buttons (g) to select the channel of the Telis 16 RTS to be used. Briefly press the up, stop, or down button corresponding to the desired function. When the intermediate position has been programmed and the end-product is stopped: briefly press the stop button: the end-product or the group of end-products is enabled at the favourite (my) position.

8. Tips and recommendations

Table with 3 columns: Observations, Possible causes, and Solutions. Covers issues like product not reacting, remote control not programmed, and external radio equipment interference.

9. Technical data

Table with 2 columns: Technical data and value. Includes Radio frequency (433.42 MHz), Protection rating (IP 30), Operating temperature (0 °C to + 60 °C), Remote control dimensions (145 x 47 x 18 mm), and Power supply (2 Type AAA (LR3) batteries).

Please separate the storage cells and batteries from other types of waste and recycle them via your local collection facility.

